

CONTENT:

DTV 160 roof fan, vertical exhaust



www.exhausto.com

EXHAUSTO

Technical data

DTV160

MODEL	DTV160-4-1
Motor	
Motor	Single-phase motor
Nominal rpm (N)	1400 rpm at 50 Hz
Electric supply (U)	1x230 V
Overload protection	Integral thermal cutout (TP211) in motor power circuit
Max absorbed current* (I)	0.14 A
Max. absorbed power (P ₁)**	0.04 kW
Motor output (P ₂)**	0.01 kW
Supply	
Supply (power cable)	3 x 0.75 mm ²
Length	0.8 m
Other data	
Weight	11 kg.

Conditions:

- * I is the maximum absorbed current throughout the control range - or the full load current if this is larger
- ** P_1 is the maximum absorbed power from the mains supply, where P_2 is the motor's nominal output.
- Stated data are for $t = 20^\circ\text{C}$
- Density = 1.2 kg/m^3
- Gas temperature: min. -12°C , max. $+60^\circ\text{C}$
- Ambient temperature: Max. $+40^\circ\text{C}$
- Pressure ratio: $< 1,11$

Capacity data

DTV160-4-1

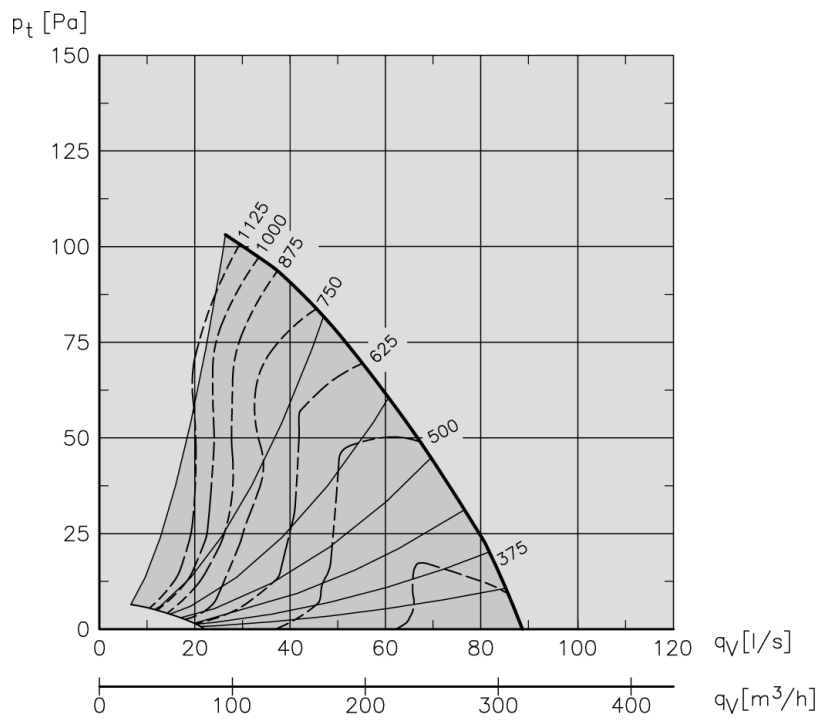

DTV160

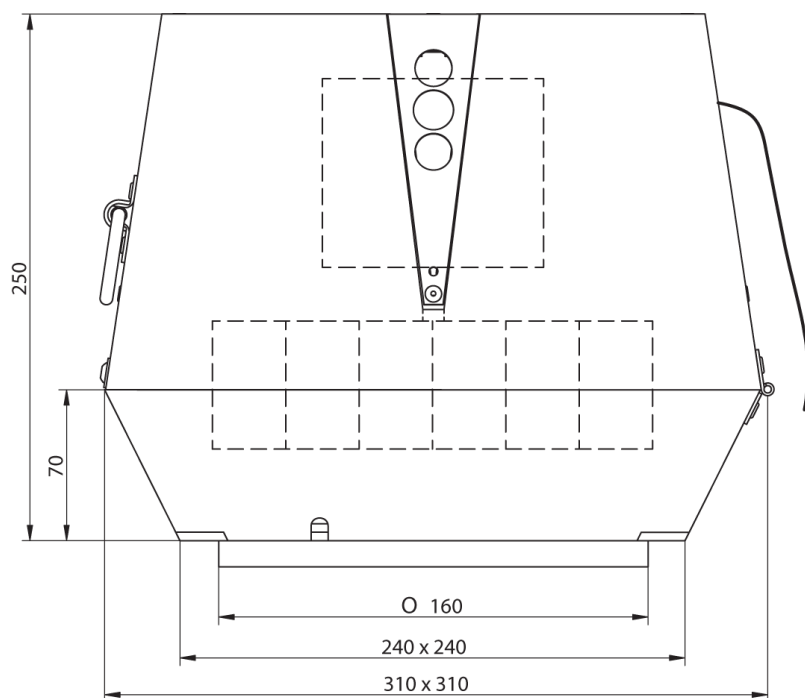

Sound data

DTV160

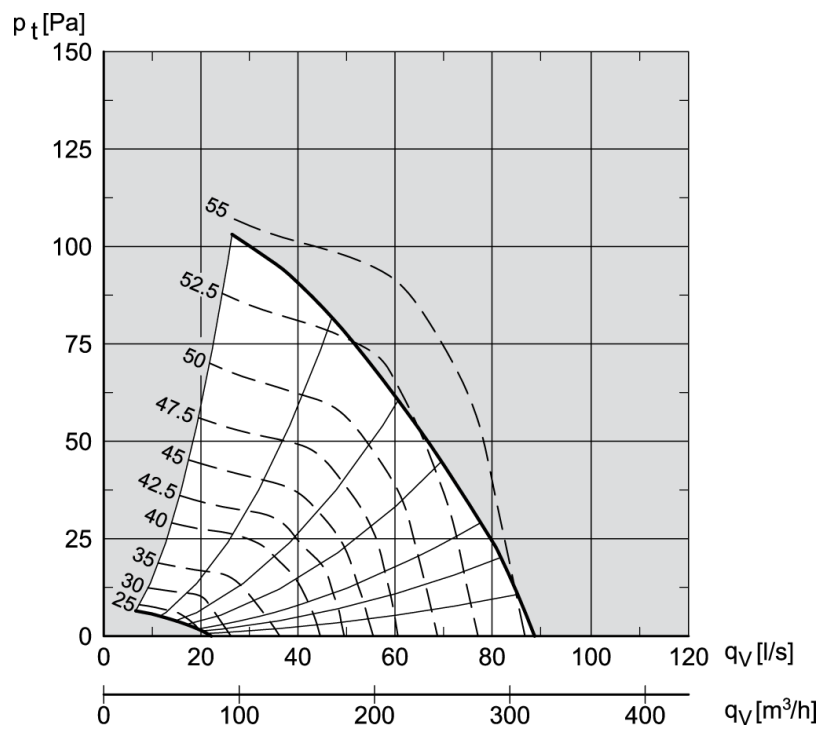

	$K_{dB(A)}$		$K_w[dB]$						
	K_{wA}	K_{pA}	125	250	500	1 k	2 k	4 k	8 k
					Hz	Hz	Hz	Hz	Hz
L_{w1}			8	2	0	-8	-20	-27	-38
L_{w3}	4		3	1	4	-2	-9	-19	-25
L_{pA3}		-23							

EXHAUSTO

Your ventilation expert and professional business partner

At EXHAUSTO we never compromise on quality, and since we are experts in ventilation with many years of specialised experience, you can be assured of not just the best ventilation solution but also a competent business partner.

EXHAUSTO develops and manufactures high-quality products and systems for comfort ventilation in all areas of use – from offices, shops, schools and institutions to industrial buildings, hotels and hospitals. With a focus on high efficiency ratings and an energy consumption which sets new industry standards, EXHAUSTO is one of the absolute leaders of the field.



LIVING RESIDENTIAL VENTILATION

Our homes are becoming steadily more airtight. This is a result of striving to bring down energy consumption. But what is good for energy consumption may be bad for indoor climate. Airtight construction makes it hard to evacuate humidity, and humidity provides good growth conditions for mould. Mould not only damages the actual building, but also leads to an unhealthy indoor climate which affects our health and well-being.



WORKING OFFICE VENTILATION

Did you know that studies have shown that a poor indoor climate can affect your employees' productivity by as much as 15%? And that the number of errors made goes up as temperatures rise above 20-22°C or CO₂ levels top 1000 ppm?



LEARNING SCHOOL VENTILATION

In less than an hour, schoolchildren hit the CO₂ wall. They become tired, get head-aches and lack concentration. A poor indoor climate impairs the teacher's working conditions and drastically reduces pupils' ability to learn.

www.exhausto.com

EXHAUSTO Export
Odensevej 76
DK-5550 Langeskov

Tel. +45 65 66 12 36
export@exhausto.dk
www.exhausto.com

EXHAUSTO